

# CATENE A RULLI DI TRASMISSIONE SERIE EUROPEA DIN 8187 ISO R 606

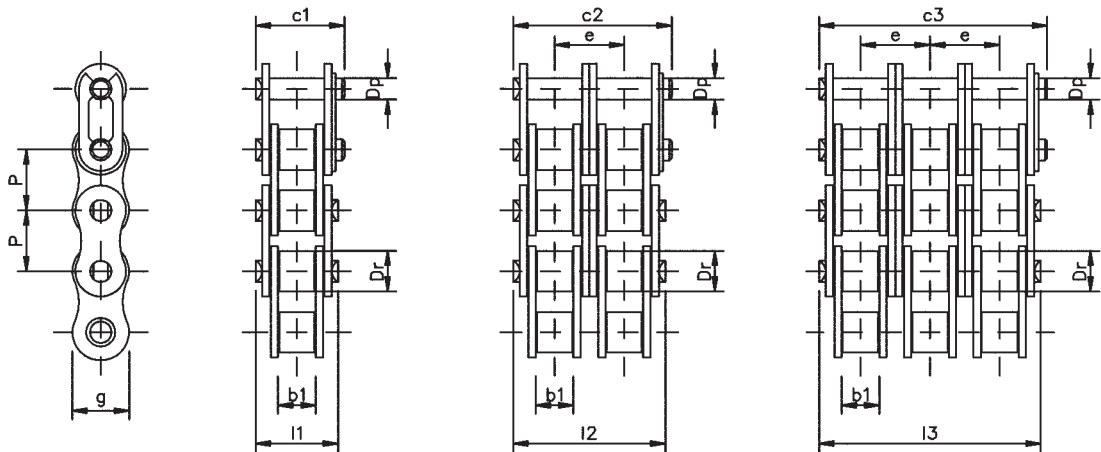

SERIE ISO	DESIGNAZIONE STANDARD	Passo (mm)	Largh. interna b1	Diametro rullo Dr	Diametro perno Dp	Lungh. perno l1-l2-l3	Lungh. perno G. c1-c2-c3	g max	e	Carico di rottura min.(N)	Peso (kg/mt)
04 B1	mm. 6 x 2,8	6,00	2,80	4,00	1,85	7,40	10,30	5,00	-	3.000	0,12
05 B1	mm. 8 x 3	8,00	3,00	5,00	2,31	8,60	11,70	7,10	-	5.000	0,18
06 B1*	3/8" x 7/32"	9,53	5,72	6,35	3,28	13,50	16,80	8,20	-	9.000	0,45
081	1/2" x 1/8"	12,70	3,30	7,75	3,66	10,20	11,70	9,91	-	8.200	0,28
082	1/2" x 3/32"	12,70	2,38	7,75	3,66	8,20	-	10,10	-	10.000	0,27
083	1/2" x 3/16"	12,70	4,88	7,75	4,09	12,90	14,40	10,30	-	12.000	0,42
084	1/2" x 3/16"	12,70	4,88	7,75	4,09	14,80	16,30	11,10	-	16.000	0,59
08 B1	1/2" x 5/16"	12,70	7,75	8,51	4,45	17,00	20,90	11,80	-	18.000	0,70
10 B1	5/8" x 3/8"	15,88	9,65	10,16	5,08	19,60	23,70	14,70	-	22.400	0,95
12 B1	3/4" x 7/16"	19,05	11,68	12,07	5,72	22,70	27,30	16,10	-	29.000	1,25
16 B1	1" x mm 17,02	25,40	17,02	15,88	8,28	36,10	41,50	21,00	-	60.000	2,70
20 B1	1" 1/4 x 3/4"	31,75	19,56	19,05	10,19	43,20	49,30	26,40	-	95.000	3,60
24 B1	1" 1/2 x 1"	38,10	25,40	25,40	14,63	53,40	60,00	33,40	-	160.000	6,70
28 B1	1" 3/4 x 1" 1/4	44,45	30,99	27,94	15,90	65,10	72,50	37,00	-	200.000	8,30
32 B1	2" x 1" 1/4	50,80	30,99	29,21	17,81	67,40	75,30	42,20	-	250.000	10,50
40 B1	2" 1/2 x 1" 1/2	63,50	38,10	39,37	22,89	82,60	92,60	52,90	-	355.000	16,00
48 B1	3" x 1" 3/4	76,20	45,72	48,26	29,24	99,10	109,10	63,80	-	560.000	25,00
06 B2*	3/8" x 7/32" doppia	9,53	5,72	6,35	3,28	23,80	27,10	8,20	10,24	16.000	0,78
08 B2	1/2" x 5/16"	12,70	7,75	8,51	4,45	31,00	34,90	11,80	13,92	32.000	1,35
10 B2	5/8" x 3/8"	15,88	9,65	10,16	5,08	36,20	40,30	14,70	16,59	40.000	1,80
12 B2	3/4" x 7/16"	19,05	11,68	12,07	5,72	42,20	46,80	16,10	19,46	53.000	2,50
16 B2	1" x mm 17,02	25,40	17,02	15,88	8,28	68,00	73,40	21,00	31,88	106.000	5,40
20 B2	1" 1/4 x 3/4"	31,75	19,56	19,05	10,19	79,70	85,80	26,40	36,45	170.000	7,40
24 B2	1" 1/2 x 1"	38,10	25,40	25,40	14,63	101,80	108,40	33,40	48,36	280.000	13,75
28 B2	1" 3/4 x 1" 1/4	44,45	30,99	27,94	15,90	124,70	132,10	37,00	59,56	360.000	17,30
32 B2	2" x 1" 1/4	50,80	30,99	29,21	17,81	126,00	133,90	42,20	58,55	450.000	19,00
40 B2	2" 1/2 x 1" 1/2	63,50	38,10	39,37	22,89	154,90	164,90	52,90	72,29	630.000	30,00
48 B2	3" x 1" 3/4	76,20	45,72	48,26	29,24	190,00	200,00	63,80	91,21	1.000.000	48,60
06 B3*	3/8" x 7/32" tripla	9,53	5,72	6,35	3,28	34,00	37,30	8,20	10,24	23.600	1,18
08 B3	1/2" x 5/16"	12,70	7,75	8,51	4,45	44,90	47,80	11,80	13,92	47.500	2,00
10 B3	5/8" x 3/8"	15,88	9,65	10,16	5,08	52,80	56,90	14,70	16,59	60.000	2,80
12 B3	3/4" x 7/16"	19,05	11,68	12,07	5,72	61,70	66,30	16,10	19,46	80.000	3,80
16 B3	1" x mm 17,02	25,40	17,02	15,88	8,28	99,90	105,30	21,00	31,88	160.000	8,20
20 B3	1" 1/4 x 3/4"	31,75	19,56	19,05	10,19	116,00	122,10	26,40	36,45	250.000	11,80
24 B3	1" 1/2 x 1"	38,10	25,40	25,40	14,63	150,00	156,60	33,40	48,36	425.000	21,00
28 B3	1" 3/4 x 1" 1/4	44,45	30,99	27,94	15,90	184,30	191,70	37,00	59,56	530.000	25,75
32 B3	2" x 1" 1/4	50,80	30,99	29,21	17,81	184,50	192,40	42,20	58,55	670.000	27,85
40 B3	2" 1/2 x 1" 1/2	63,50	38,10	39,37	22,89	227,00	237,00	52,90	72,29	950.000	44,80
48 B3	3" x 1" 3/4	76,20	45,72	48,26	29,24	281,60	291,60	63,80	91,21	1.500.000	72,50

\* Disponibile solo con piastre a profilo diritto (tipo "C")

Versioni alternative: - con piastre a profilo diritto (Tipo "C") - con trattamento di nichelatura, zincatura - in acciaio inox AISI 304